

THIS DRAWING IS UNPUBLISHED. RELEASED FOR PUBLICATION 2000

© COPYRIGHT 2000 BY TYCO ELECTRONICS CORPORATION. ALL RIGHTS RESERVED.

LOC	DIST	REVISIONS				
P	LTR	DESCRIPTION	DATE	DWN	APVD	
GW	-	A1	SR10-0146-01	09APR2001	CM	KM
		A2	REV PER ECO-09-026495	01NOV09	KK	AEG

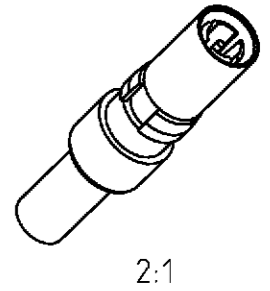
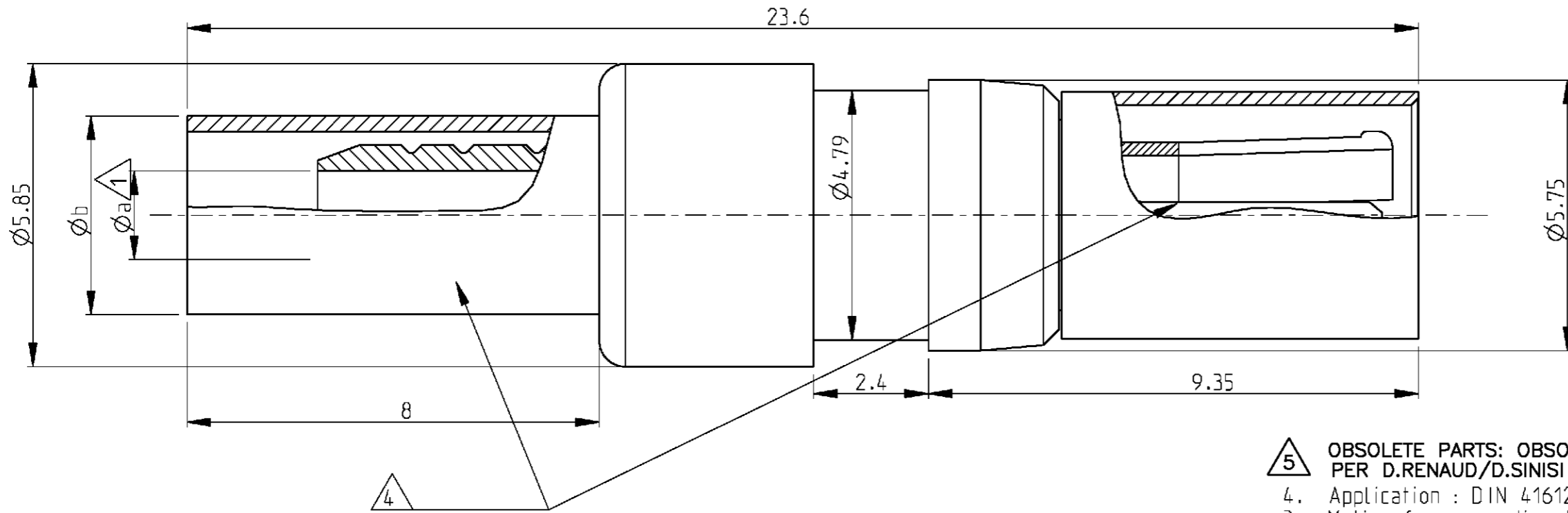

- 5 OBSOLETE PARTS: OBSOLETE CIS STREAMLINING PER D.RENAUD/D.SINISI
 - 4. Application : DIN 41612 Type M
 - 3. Mating face according to DIN 41626 Part 2
 - 2. Supplied as loose part
 - 1 Minimum dimension
- All dimensions are max dimensions unless otherwise specified

Old Nr	Tyco Nr	Cable Type	Dim a	Dim b	Description	Material	Plating
5 OBSOLETE V23615-B302-E57A	3-1393668-1	RG179 B/U	1.7	3.85	Dielectric	PTFE	
					Outer Con.	Cu Be	1µm Au min in contact area
					Center Con.	Brass	1µm Au min in contact area
V23615-B302-E57	3-1393668-0	RG179 B/U	1.7	3.85	Dielectric	PTFE	
					Outer Con.	Cu Be	1µm Au min in contact area
					Center Con.	Brass	1µm Au min in contact area



<small>THIS DRAWING IS A CONTROLLED DOCUMENT FOR TYCO ELECTRONICS CORPORATION. IT IS SUBJECT TO CHANGE AND THE CONTROLLING ENGINEERING ORGANIZATION SHOULD BE CONTACTED FOR THE LATEST REVISION.</small>		DWN MOROBE 03APR2001 CHK MATTHEEUS 9APR2001 APVD BOZZER 9APR2001	tyco Electronics Tyco Electronics Oostkamp - Belgium
DIMENSIONS: mm	TOLERANCES UNLESS OTHERWISE SPECIFIED: 0 PLC ±0.5 1 PLC ±0.13 2 PLC ±0.013 3 PLC ±0.0001 4 PLC ANGLES ±	PRODUCT SPEC 108-71032 APPLICATION SPEC 114-71015 WEIGHT -	NAME CABLE PLUG 1.0/2.3 INSERT 75 Ohm
MATERIAL -	FINISH -	SIZE A3	CAGE CODE 00779 DRAWING NO C-3-1393668-0 RESTRICTED TO -
		SCALE 10/1	SHEET 1 OF 1 REV A2